

VEL Exhaust valve

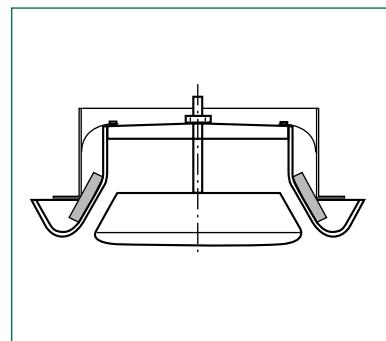

VEL exhaust valve are circular valves with a valve cone of aerodynamic design. These valves possess excellent characteristics with regard to noise level, pressure drop and air flow capacity. VEL is available in three models: standard with a fixed setting; with a timer or with a electric motor (24 V or 230 V) for automatic resetting from a forced flow to a basic flow.

Quick selection

| VEL-10 | Air flow l/s (m ³ /h) at sound level | | |
|------------------------------|---|----------|-------|
| | 25 dB | 30 dB | 35 dB |
| Standard - fixed setting | 28 | 33 (119) | 40 |
| Timer | 22 | 27 (97) | 31 |
| 24 V or 230 V electric motor | 18 | 22 (79) | 26 |

Product facts

VEL Exhaust valve

Designed for wall or ceiling mounting.

Excellent characteristics with regard to noise level, pressure drop and air flow capacity.

VEL is available in three models.

Suitable for 100 mm diameter duct connection.

Manufactured of polypropylene plastic.

Product code example

Standard exhaust valve with fixed setting VEL-10-0-1

Air flow, pressure drop, sound level

VEL-10 standard with fixed setting

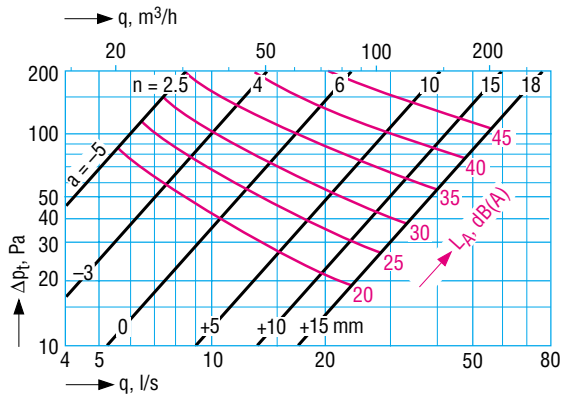

VEL-10 with 24 V or 230 V electric motor

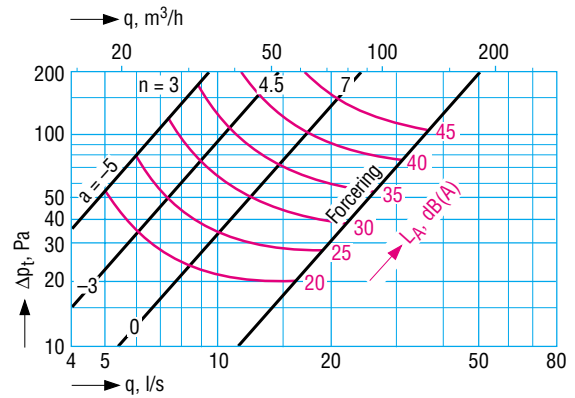

The graphs relate to air at a density of 1.2 kg/m³. The indicated sound levels relate to room attenuation of 4 dB.

VEL-10 with timer

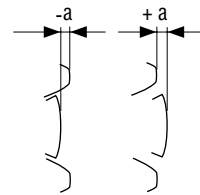
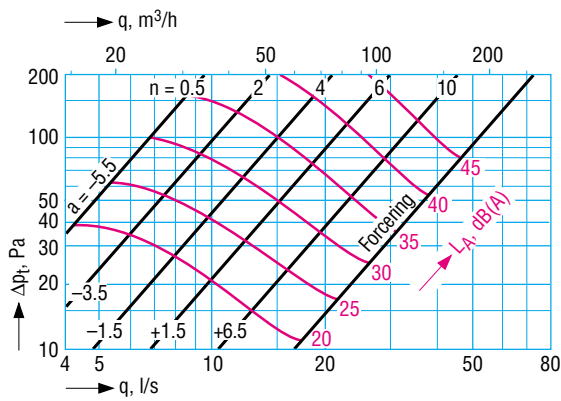

n = number of revolutions open a = slot orifice in mm

Maintenance

The device can be wiped down with a mild detergent.

Sound data, dimensions, adjustment, material

Sound power level

| Model | Correction of sound level in dB at | | | | | | | |
|----------|------------------------------------|-----|-----|-----|------|------|------|---------|
| | 63 | 125 | 250 | 500 | 1000 | 2000 | 4000 | 8000 Hz |
| Standard | -10 | -2 | 0 | -2 | 0 | -2 | -6 | -17 |
| Timer | -10 | -2 | +5 | +4 | -4 | -7 | -13 | -26 |
| Motor | -3 | -1 | +3 | +2 | -1 | -3 | -9 | -20 |

Sound attenuation

| Model | Correction of sound level in dB at | | | | | | | |
|-------|------------------------------------|-----|-----|-----|------|------|------|---------|
| | 63 | 125 | 250 | 500 | 1000 | 2000 | 4000 | 8000 Hz |
| All | 19 | 18 | 12 | 10 | 8 | 7 | 3 | 6 |

Dimensions and weights

VEL-10 standard with fixed setting

Weight: 0,15 kg

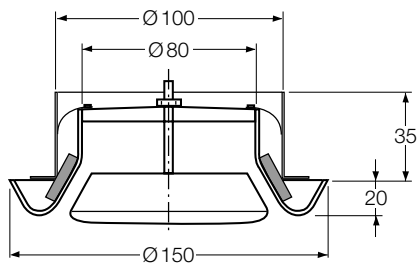

VEL-10 with timer

Weight: 0,25 kg

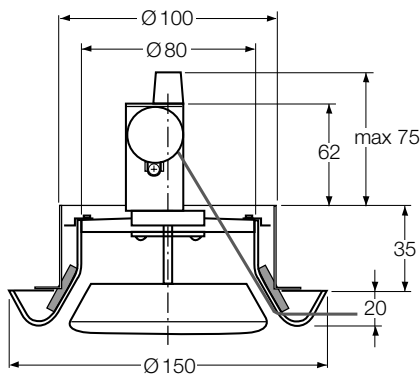

VEL-10 with 24 V or 230 V electric motor

Weight: 0,35 kg

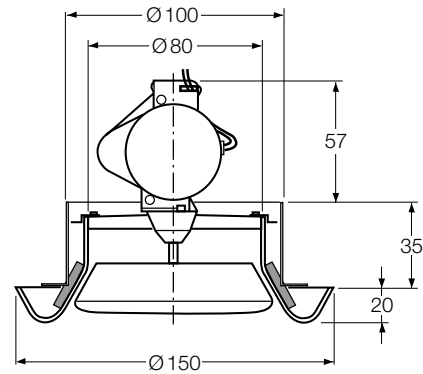

Adjustment

The cone is screwed out or in by the number of revolution necessary to provide the orifice opening in mm corresponding to the pressure drop and the desired air flow according to the graph. The pressure drop is checked by introducing a suitable measurement probe into the front behind the valve cone.

Material

The devices are made of polypropylene plastic which is recyclable and withstands temperatures up to 100 °C. The devices are supplied in white as standard. Certain special colours are available if ordered in large quantities. Galvanized steel sheet mounting rings are available as an accessory.

Application, product code

Application

VEL exhaust valves are circular valves with a valve cone of aerodynamic design. These valves possess excellent characteristics with regard to noise level, pressure drop and air flow capacity. VEL is available in three models: with a fixed setting; with a timer, or with a 24 V or a 230 V electric motor for automatic resetting from a forced flow to a basic flow. The valves, which are designed for wall-mounting or, alternatively, for ceiling-mounting, are available in a size to suit a 100 mm diameter duct connection. The design of the valve in conjunction with a Moltopren packing prevents dirtying of the ceiling and walls.

VEL Standard with fixed setting

This device has lockable adjustment and is readily preset to the calculated pressure drop for a given air flow. The valve cone is locked with nuts. The device can be supplied with two mounting alternatives, with a compression spring or a bayonet spring.

VEL with Timer

This device, which is fitted with a timer, is intended for bathrooms and shower rooms. The device is constructed to permit the air flow to be forced to a minimum value of 20 l/s and is regulated with a cord. Switching to a forced flow starts a timer, which resets the device to its basic flow after 15, 30 or 60 minutes. The time must be indicated when ordering. The basic flow is easily set by screwing the valve cone in or out to the position corresponding to the desired pressure drop and air flow. Devices with a timer are always fitted with a bayonet spring. A mounting frame and a draught relief valve are supplied as standard.

VEL with 24 or 230 V electric motor

This device, which is intended for bathrooms and shower rooms in systems with a central exhaust air fan, is equipped with either a 24 V electric motor connected via a transformer (not included in the supply) or alternatively a 230 V electric motor. Switching to a forced flow is by means of a switch, for example a lightactivated switch. Resetting to the basic flow is normally automatic when the power supply is interrupted. The basic flow is easily set by screwing the valve cone in or out to the position corresponding to the desired pressure drop and air flow. The device is easily set by screwing the valve cone in or out to the position corresponding to the desired pressure drop and air flow. The device can be supplied with two mounting alternatives, with a compression spring or a bayonet spring.

Descriptive text

VEL-10 exhaust valve manufactured by Fläkt Woods: with fixed setting/with timer including mounting frame and draught relief valve/with a 24 V or a 230 V electric motor.

Product code

Exhaust valve with fixed setting **VEL-10-0-b**

Installation _____

0 = with compression spring

1 = with bayonet spring

Exhaust valve with timer **VEL-10-1-1-c**

Resetting of timer _____

1 = 15 minutes

2 = 30 minutes

3 = 60 minutes

Exhaust valve with electric motor **VEL-10-a-b**

Electric motor _____

4 = 24 V

5 = 230 V

Installation _____

0 = with compression spring

1 = with bayonet spring

Mounting ring **VLZ-01-10**

(compression spring, without rubber seal)

Mounting ring **VLZ-02-10**

(compression spring, with rubber seal)

Mounting ring **VLZ-03-10**

(bayonet spring, without rubber seal)

Adjustment kit **VLZ-07-aa**

Measurement probe and adjustment data for each size